

PAINT COLORS BY BENJAMIN - MOORE  
16-12



INSTALL LIGHT COLORED CURTAINS IN WINDOWS.

REMOVE EXISTING ORNAMENTAL METAL POST AND RAILING. ADD NEW WOOD COLUMNS AND TURNED WOOD SPINDLES AND RAILING. PAINT SAME COLOR AS TRIM.

PLANT NEW SHRUBS SAME AS ON RIGHT SIDE OF PORCH

RETAIN EXISTING TRIM COLOR AND SIDING AS IS.

PAINT STAIRS AND RAILING 16-12

RETAIN EXISTING STAIR RAILING. PAINT SAME COLOR AS TRIM.

302 E. WALNUT

BLOOMINGTON, IL

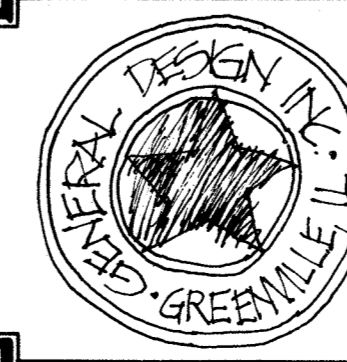

GENERAL DESIGN, INC  
214 n. 3<sup>d</sup> greenville, illinois (618) 664-2332

SHEET

11

SEPT. 78



\* ORIGINAL CONDITION OF  
302 E. WALNUT

\* "SCALING" & WOOD SHINGLES

\* ORIGINAL PORCH IS SHOWN. LATER  
THE PORCH WAS EXTENDED ON THE  
WEST END TO MEET THE CORNER  
TOWER

\* WINDOW HAS BEEN REMOVED

☆  
\* DUE TO THE AVAILABILITY OF ONLY  
BLACK & WHITE PHOTOGRAPHS OF  
ORIGINAL HOUSE, ORIGINAL COLORS ARE  
NOT KNOWN. COLORS SHOWN HERE  
ARE TO ILLUSTRATE TONES  
AND CONTRAST USED IN ORIGINAL  
SCHEME.

\* WOOD SHINGLES AND "SCALING"  
PATTERNS ORIGINALLY PART OF  
DETAILING, ON CENTRAL GABLE OF  
THIRD FLOOR, ON TOWER (corner),  
AND ON PORCH ROOF GABLE, HAVE  
SINCE BEEN REMOVED

\* DOUBLE COLUMN ARRANGEMENT  
AT CORNER OF PORCH

302 E. WALNUT

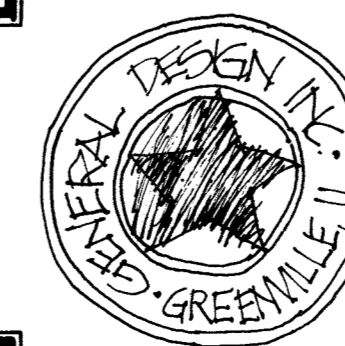

**GENERAL DESIGN, INC**  
214 n. 3<sup>d</sup> greenville, illinois (618) 664-2332

SHEET

2

• PAINT COLORS BY  
BENJAMIN MOORE'S

17-9

17-6

18-111

• INSTALL LIGHT COLORED  
CURTAINS IN FIRST AND  
SECOND STORY WINDOWS

• PAINT SIDE BOARDING ON  
EXTERIOR OF HOUSE  
17-6

• PAINT EXTERIOR TRIM 17-9

• CLEAN AND TUCKPOINT  
BRICK AS NECESSARY

• INSTALL FANCY GINGERBREAD  
SPINDLE DESIGN PATTERNS IN  
UPPER STORY WINDOW. PAINT  
DETAILS 17-6. PAINT BACKGROUND 17-9

• REMOVE FIRE EXIT LADDER  
FROM PORCH ROOF

• INSTALL NEW WOODEN SHUTTERS  
ON FIRST AND SECOND STORY  
WINDOWS. PAINT 18-111

• INSTALL NEW SPINDLE TYPE RAILING  
TO REPLACE EXISTING MODERN  
STYLE. PAINT 17-6

• ARRANGE NEW PLANTINGS IN  
ORDERLY FASHION AROUND  
FRONT PORCH AND HOUSE  
FOUNDATION

310 E. WALNUT

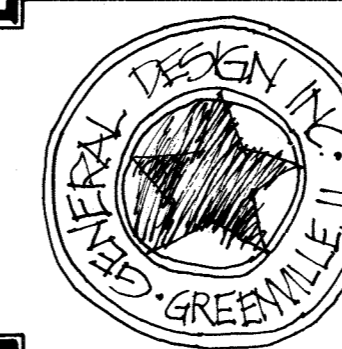

GENERAL DESIGN, INC  
214 n. 3<sup>d</sup> greenville, illinois (618) 664-2332

SHEET

1  
SEPT '78

° PAINT COLORS BY  
BENJAMIN MOORE  
18-1  
18-95  
18-127

18-1

18-95

18-127

° PAINT TRIM AND  
DETAILING  
18-1

° INSTALL WOODEN  
SHUTTERS  
PAINT 18-127

° INSTALL LIGHT COLORED  
CURTAINS IN WINDOWS

° PAINT ENTIRE PORCH, TRIM,  
RAILINGS 18-1

° PAINT SCAFFOLD 18-95

° PAINT EXTERIOR WALLS  
18-95



410 E. WALNUT

BLOOMINGTON, IL.

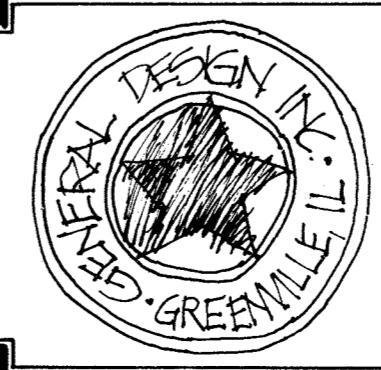

GENERAL DESIGN, INC  
214 n. 3<sup>d</sup> greenville, illinois (618) 664-2332

SHEET

11  
SEPT. 78

- PAINT COLORS BY BENJAMIN-MOORE
- 17-3
- 17-20
- 17-24

• 17-3

• 17-20

• 17-24

• INSTALL CUT WOOD GABLE ORNAMENT PAINT 17-20

• PAINT SHUTTERS 17-24

• PAINT 17-24

• PAINT VENT 17-24  
• PAINT FRAME 17-20

• PAINT WINDOW FRAME, SILLS AND LINTELS 17-20

• PAINT WALLS 17-3

• PAINT GUTTER + TRIM 17-24

PORCH

- REMOVE EXISTING PORCH POSTS AND ARCHED DECORATION. REPLACE WITH TURNED WOOD POSTS AND SPINDLES AND CUT WOOD DECORATION AT BASE OF TOP RAILING. PAINT 17-20 UNLESS OTHERWISE NOTED.
- PAINT 17-24

• PAINT SOFFIT 17-3

• PAINT WINDOW SASH AND JAMBS 17-24

• INSTALL LIGHT COLORED CURTAINS IN WINDOWS.

• PAINT DOOR FRAME 17-20

• PAINT DOOR 17-24

• PAINT PORCH FLOOR AND STEPS 17-24

• PLANT LOW GROWING SHRUBS IN FRONT OF PORCH.

305 E. CHESTNUT

BLOOMINGTON, IL.

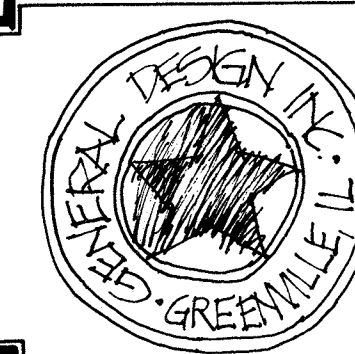

**GENERAL DESIGN, INC**  
214 n. 3<sup>d</sup> greenville, illinois (618) 664-2332

SHEET

1

SEPT. 78

• PAINT COLORS BY BENJAMIN-MOORE  
 • 16-1  
 • 17-5

• 16-1

• 17-5

• PAINT STUCCO WALLS 17-5

• REMOVE GARBAGE SHRUBS AND  
 PLANT NEW MORE UNIFORM SHRUBS.



• PAINT ALL TRIM, WINDOW  
 SASH + JAMBS, SILLS AND LINTELS, ETC.  
 16-1.

• INSTALL LOUVERED WOODEN  
 SHUTTERS FOR ALL WINDOWS  
 PAINT 16-1.

• INSTALL LIGHT COLORED  
 CURTAINS IN UPPER AND  
 LOWER WINDOWS.

• PAINT DOOR AND PORCH TRIM  
 16-1.

315 E. CHESTNUT

BLOOMINGTON, IL

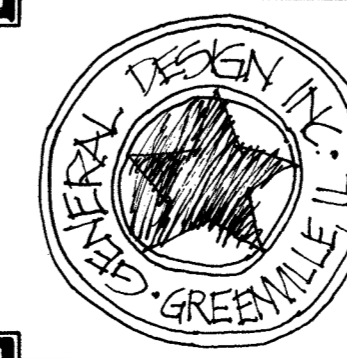

**GENERAL DESIGN, INC**  
 214 n. 3<sup>d</sup> greenville, illinois (618) 664-2332

SHEET

1

SEPT. 78



◦ ORIGINAL CONDITION AND APPEARANCE OF BUILDING IS SHOWN. COLORS USED ARE ONLY TO GIVE CONTRAST AND TONES OF ORIGINAL SINCE ONLY BLACK & WHITE PHOTOGRAPHS OF ORIGINAL EXIST. EXACT COLORS NOT KNOWN UNTIL PAINT SCRIBINGS CAN BE CONDUCT BY ARCHITECTS.

◦ ORIGINALLY WOOD HORIZONTAL SIDING COVERED EXTERIOR. HOUSE NOW HAS EXTERIOR STUCCO FINISH.

◦ WROUGHT IRON PORCH ROOF DECK RAILINGS. [no longer existing]

◦ METAL PORCH ROOF [NOW REMOVE WITH ENTIRE WOODEN FRONT PORCH]

◦ WOODEN POSTS AND WOODEN BRACKET [no longer existing]

◦ PORCH NOW COMPLETELY REMOVED

315 E. CHESTNUT

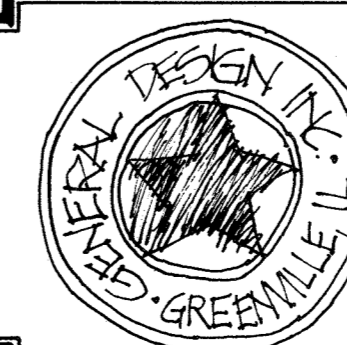

**GENERAL DESIGN, INC**  
214 n. 3<sup>d</sup> greenville, illinois (618) 664-2332

SHEET

2

SEPT '78

• PAINT COLORS BY BENJAMIN-MOORE  
 • 18-103  
 • 20-72

• 18-103

• 20-72

• PAINT GUTTER AND  
 DOWN SPOUT 20-72

• PAINT WINDOW SASH 18-103

• PAINT JAMBS, SILLS, +  
 LINTELS 20-72

• PAINT 18-103

• PAINT PORCH 20-72  
 UNLESS OTHERWISE NOTED

• PAINT 18-103

• PAINT TRIM 20-72

• RETAIN EXISTING SIDING AS IS.

• PAINT VENT 20-72

• INSTALL LOUVERED WOOD  
 SHUTTERS, PAINT 20-72

• INSTALL LIGHT COLORED CURTAINS  
 IN WINDOWS.



321 E. CHESTNUT

BLOOMINGTON, IL

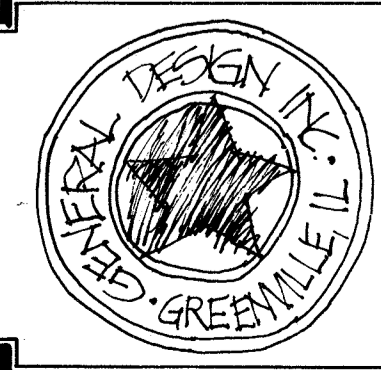

**GENERAL DESIGN, INC**  
 214 n. 3<sup>d</sup> greenville, illinois (618) 664-2332

SHEET

1  
 SEPT. 78

- PAINT COLORS BY BENJAMIN-MOORE
- 18-18
- 18-94
- 18-111

• 18-18

• 18-94

• 18-111

- ADD POSTS AND RAILING ATOP ROOF AS SHOWN. (ALL WOOD CONSTRUCTION.)
- 18-94
- 18-111

• PAINT 18-111

• PAINT 18-94

• PAINT BRACKETS 18-111

• PAINT MOULDING 18-111

• PAINT LINTELS 18-94

• INSTALL LIGHT COLORED CURTAINS IN ALL WINDOWS.

• PAINT WINDOW SASH & JAMBS 18-111

• PAINT WINDOW SILLS 18-94

• PAINT WALLS 18-18

• PAINT 18-18

• PAINT 18-94

• PAINT DOOR AND SIDE LIGHTS 18-111.

• PAINT MOULDED AREA 18-94

• PAINT DOOR JAMBS 18-111

• PAINT 18-94

• PAINT 18-111

901 N. McLEAN

BLOOMINGTON, IL.

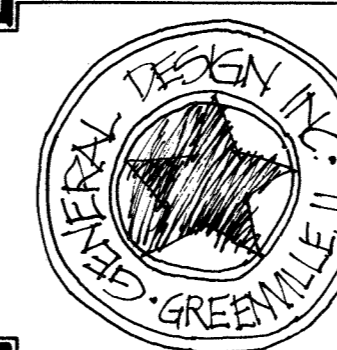

**GENERAL DESIGN, INC**  
214 n. 3<sup>d</sup> greenville, illinois (618) 664-2332

SHEET

1

SEPT. 78

° ORIGINAL CONDITION AND  
 APPEARANCE OF BUILDING IS SHOWN  
 COLORS USED ARE ONLY TO GIVE  
 CONTRAST AND TONES OF ORIGINAL  
 SINCE ONLY BLACK + WHITE PHOTO-  
 GRAPHS OF ORIGINAL EXIST. EXACT  
 COLORS NOT KNOWN UNTIL PAINT  
 SCRAPINGS CAN BE CONDUCT BY  
 ARCHITECTS.

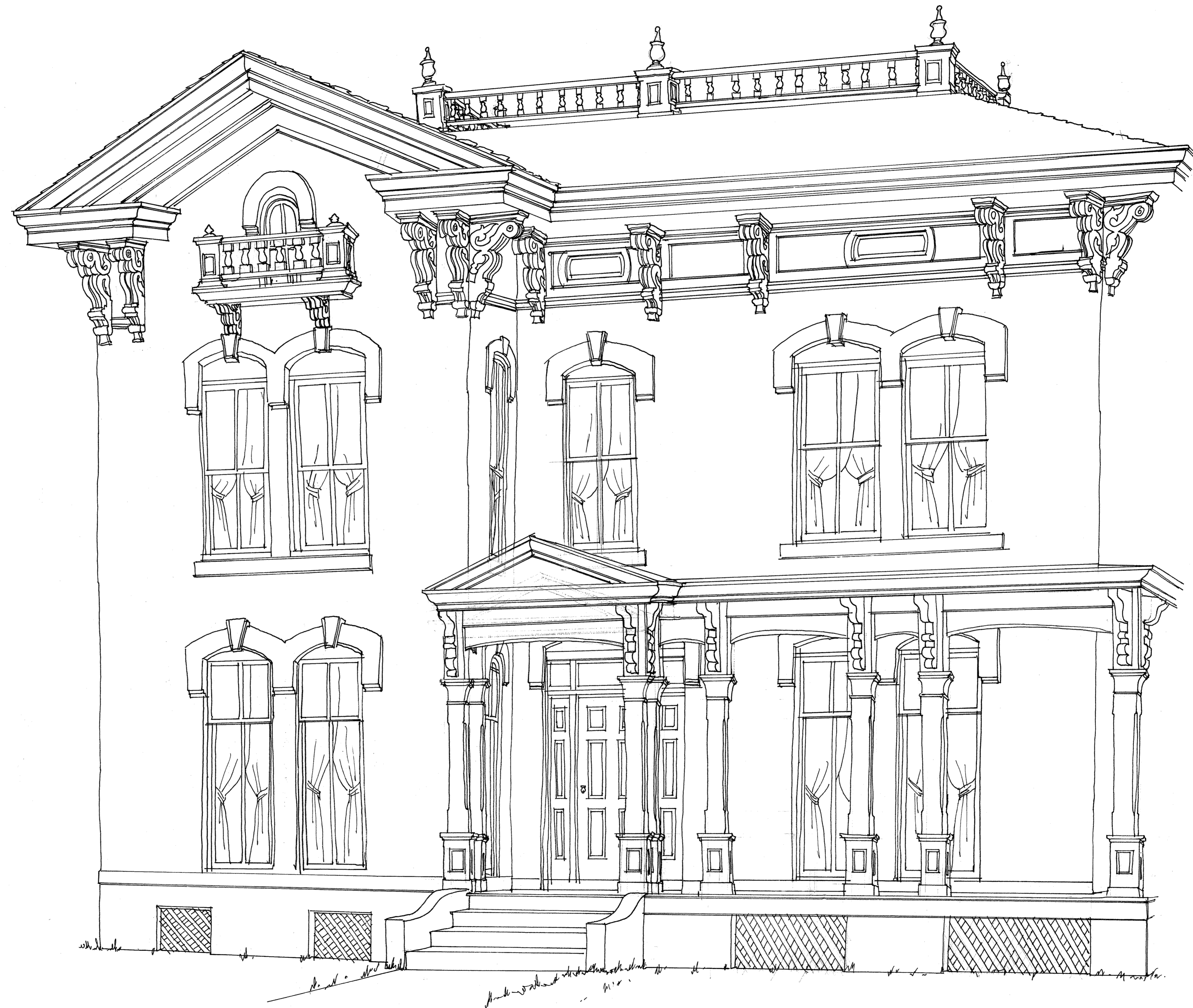

901 N. McLEAN

BLOOMINGTON, IL.

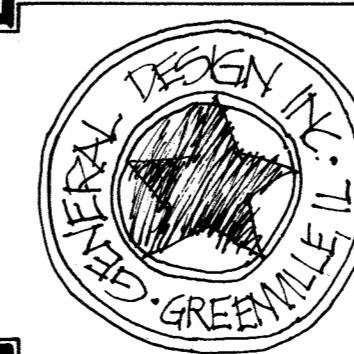

**GENERAL DESIGN, INC**  
 214 n. 3<sup>d</sup> greenville, illinois (618) 664-2332

SHEET

2

SEPT. 78

° PAINT COLORS BY  
 BENJAMIN MOORE'S  
 • 17-20  
 • 17-22

17-20

17-22

° PAINT ALL EXTERIOR WALLS  
 17-22

° PAINT ALL DETAIL AND TRIM  
 17-20

° REPAIR OR REPLACE DAMAGED  
 OR DETERIORATED BOX WOODEN  
 GUTTERS. PAINT 17-20

° INSTALL NEW FABRIC AWNING  
 USE "MOCHA", STYLE # 1116  
 as made by  
 SUNBrella AWNING  
 FABRIC CO.  
 GLENN RAVEN MILLS  
 GLENN RAVEN, D.C.  
 27215

° PAINT ENTIRE PORCH & RAILINGS,  
 POSTS, TRIM, ETC. PAINT 17-20



907 N. McLEAN

BLOOMINGTON, IL

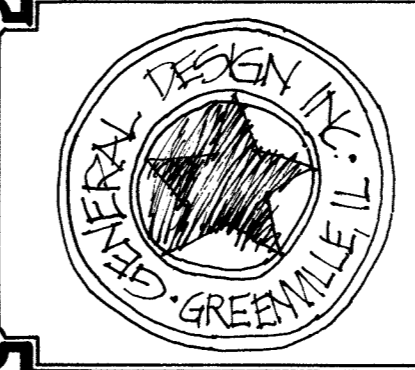

**GENERAL DESIGN, INC**  
 214 n. 3<sup>d</sup> greenville, illinois (618) 664-2332

SHEET  
 1  
 SEPT. 78

• 18-34

• 18-111

- PAINT COLORS BY BENJAMIN MOORE
- 18-34
- 18-111

• INSTALL EVENLY PUCKERED LIGHT COLORED CURTAINS IN WINDOWS

• REPAIR WOODEN GUTTER WHERE NEEDED  
PAINT 18-34

• RETAIN EXISTING BRICK & STONE AS IS, CLEAN AND TUCK POINT IF NEEDED.

• PAINT ALL WOODEN SURFACES 18-34 (COLUMNS, BRACKETS, WINDOW SASHES, DOORS, JAMBS, TRIM, ETC.) UNLESS OTHERWISE NOTED.

• RETAIN EXISTING FABRIC AWNINGS.

• PAINT PORCH FLOOR AND TOP OF STEPS 18-111. (USE AN ENAMEL BASE FOR PAINT.)



909 N. McLEAN

BLOOMINGTON, IL

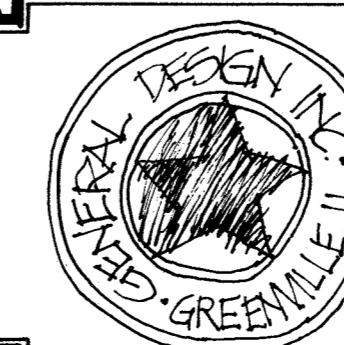

**GENERAL DESIGN, INC**  
214 n. 3<sup>d</sup> greenville, illinois (618) 664-2332

SHEET

1

AUG. 78

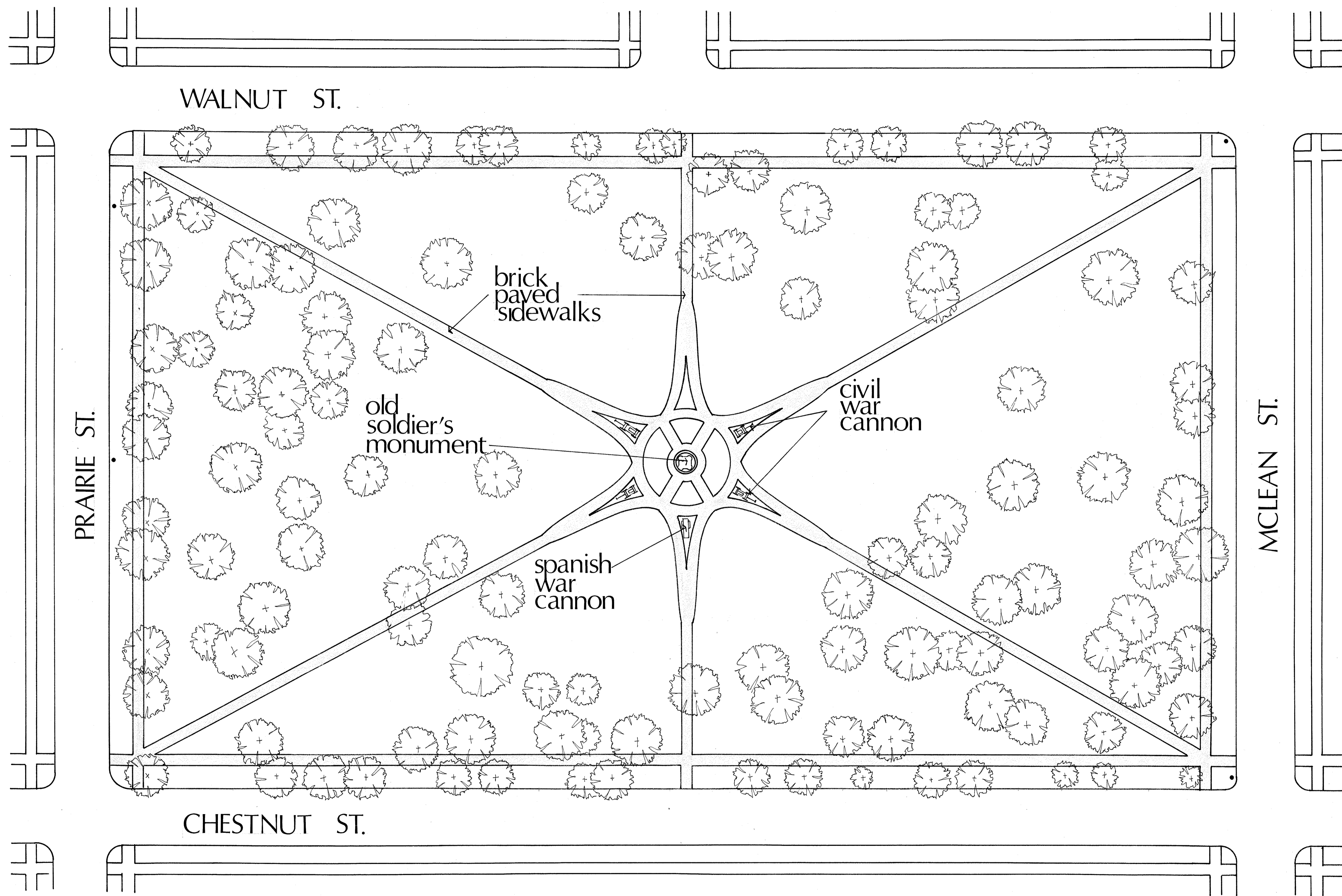

FRANKLIN SQUARE -- TURN OF THE CENTURY (1900)

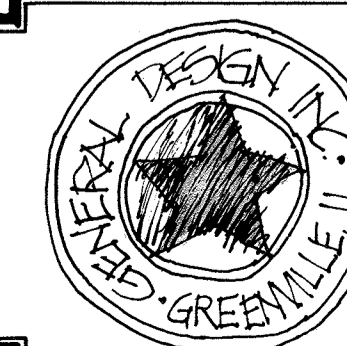
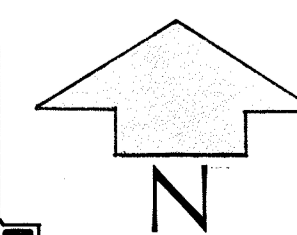

**GENERAL DESIGN, INC**  
 214 n. 3<sup>d</sup> greenville, illinois (618) 664-2332

SHEET

1  
 AUG. 78

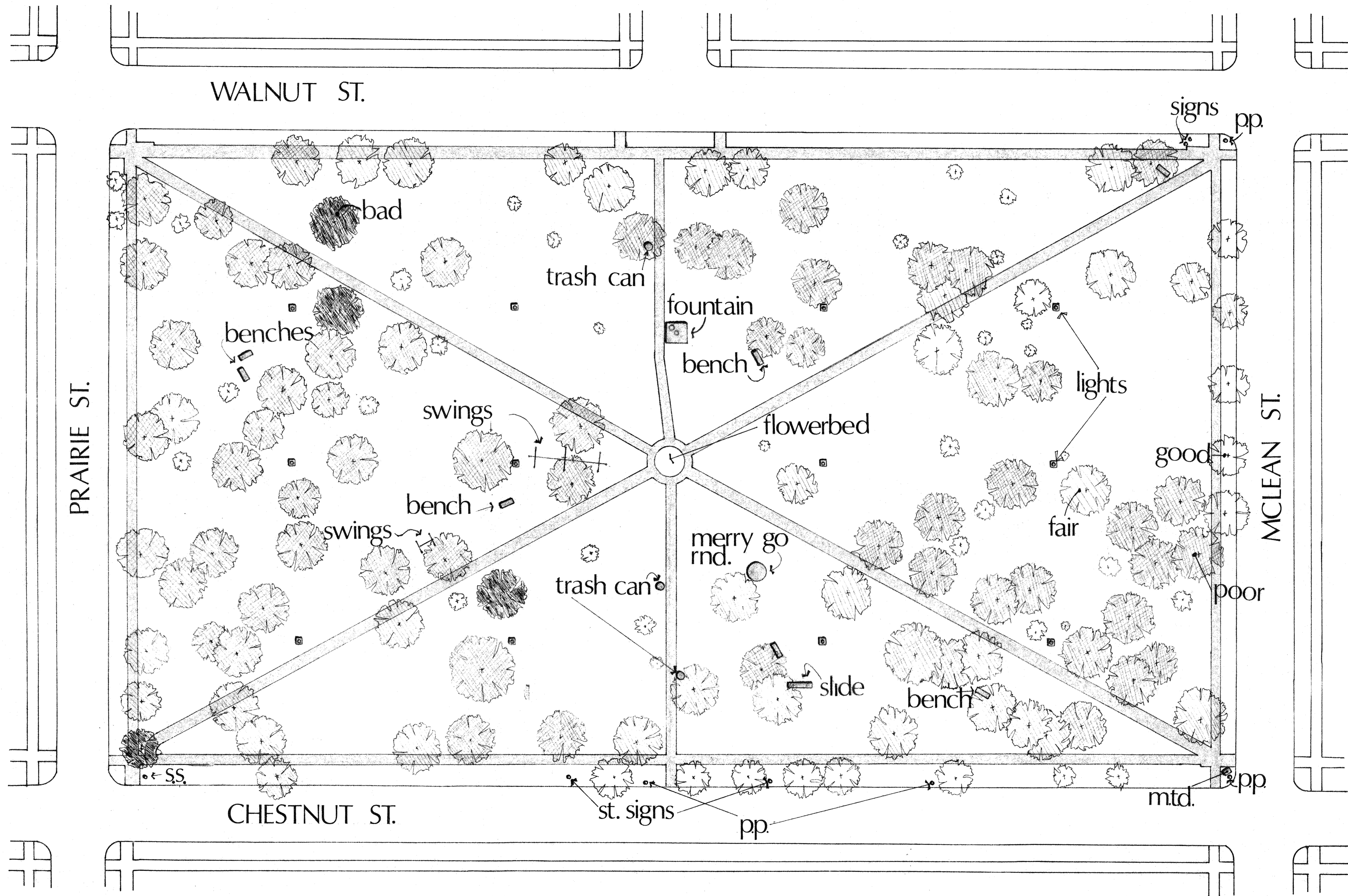

FRANKLIN SQUARE - EXISTING (AUG. 78)

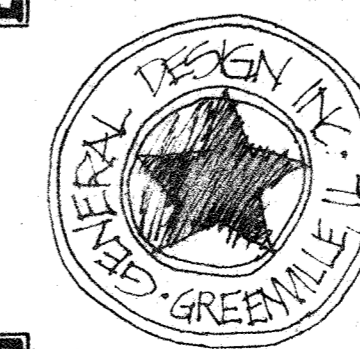
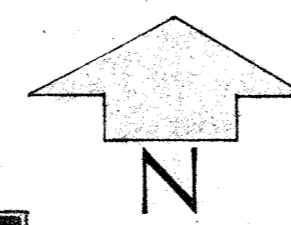

GENERAL DESIGN, INC  
 214 n. 3<sup>d</sup> greenville, illinois (618) 664-2332

SHEET

2  
 AUG. 78

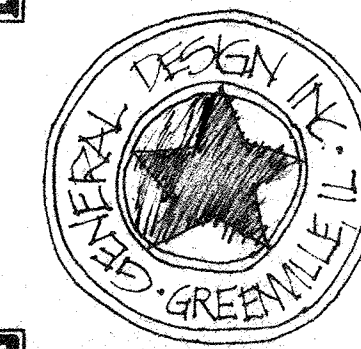
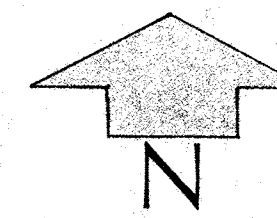
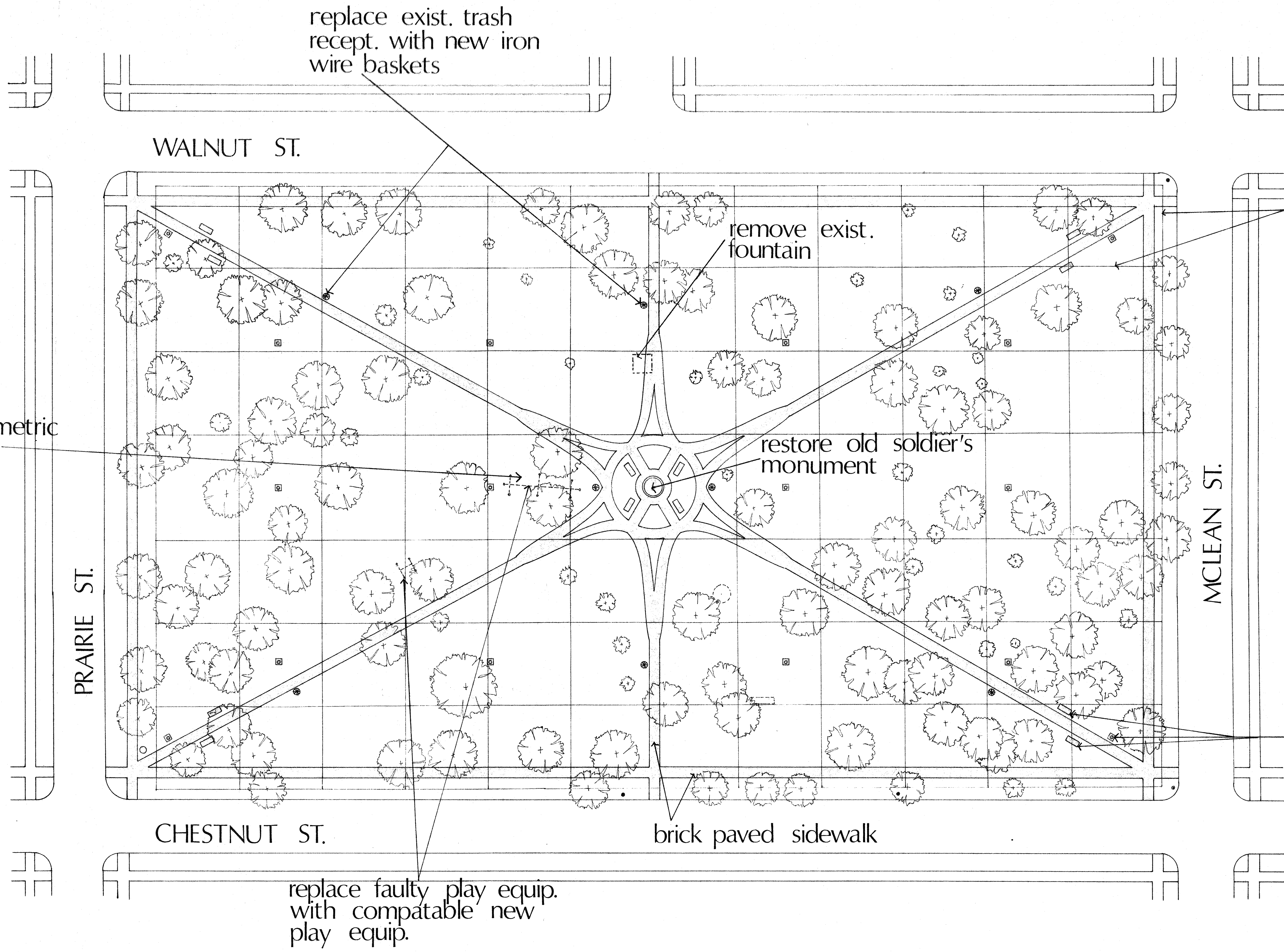

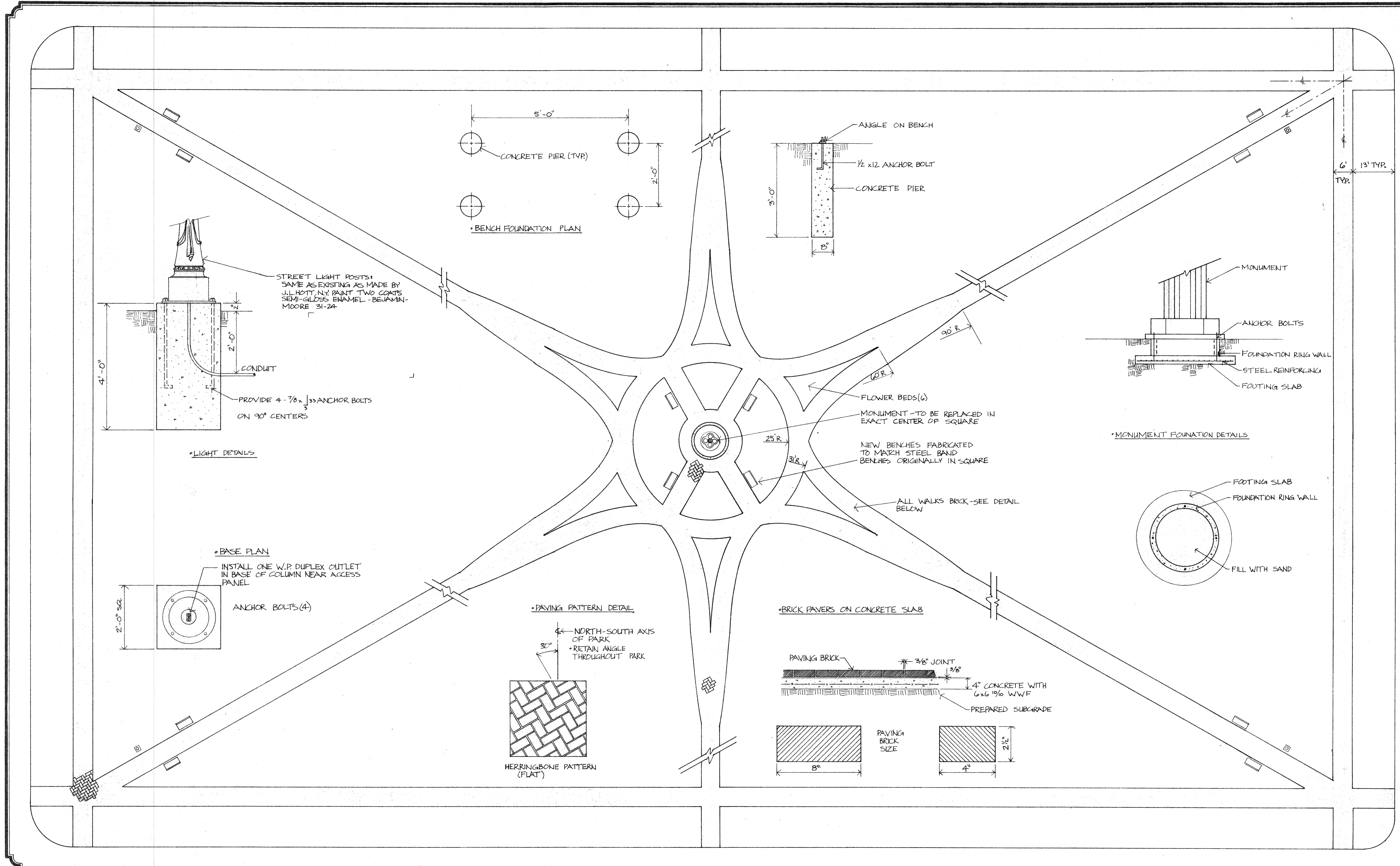

FRANKLIN SQUARE DETAILS

BLOOMINGTON, IL

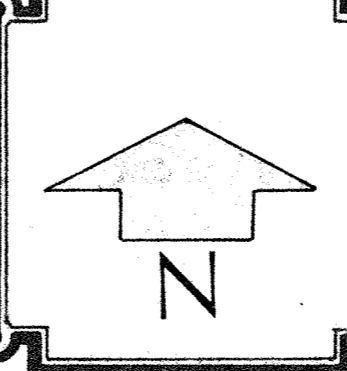

**GENERAL DESIGN, INC**  
 214 n. 3<sup>d</sup> greenville, illinois (618) 664-2332

SHEET  
**4**  
 AUGUST 1978

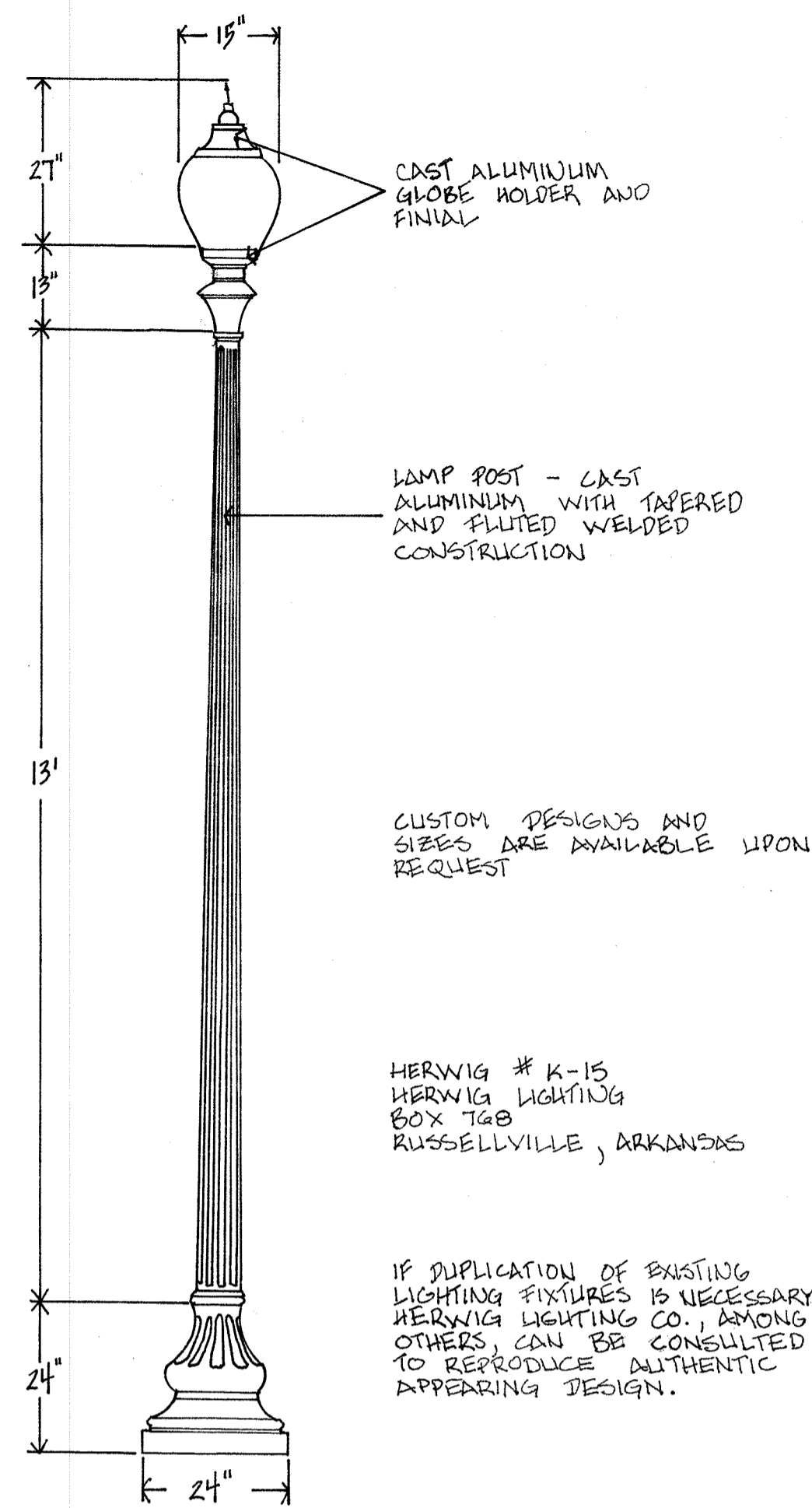

ALTERNATE FIXT.  
1/2" = 1'-0"

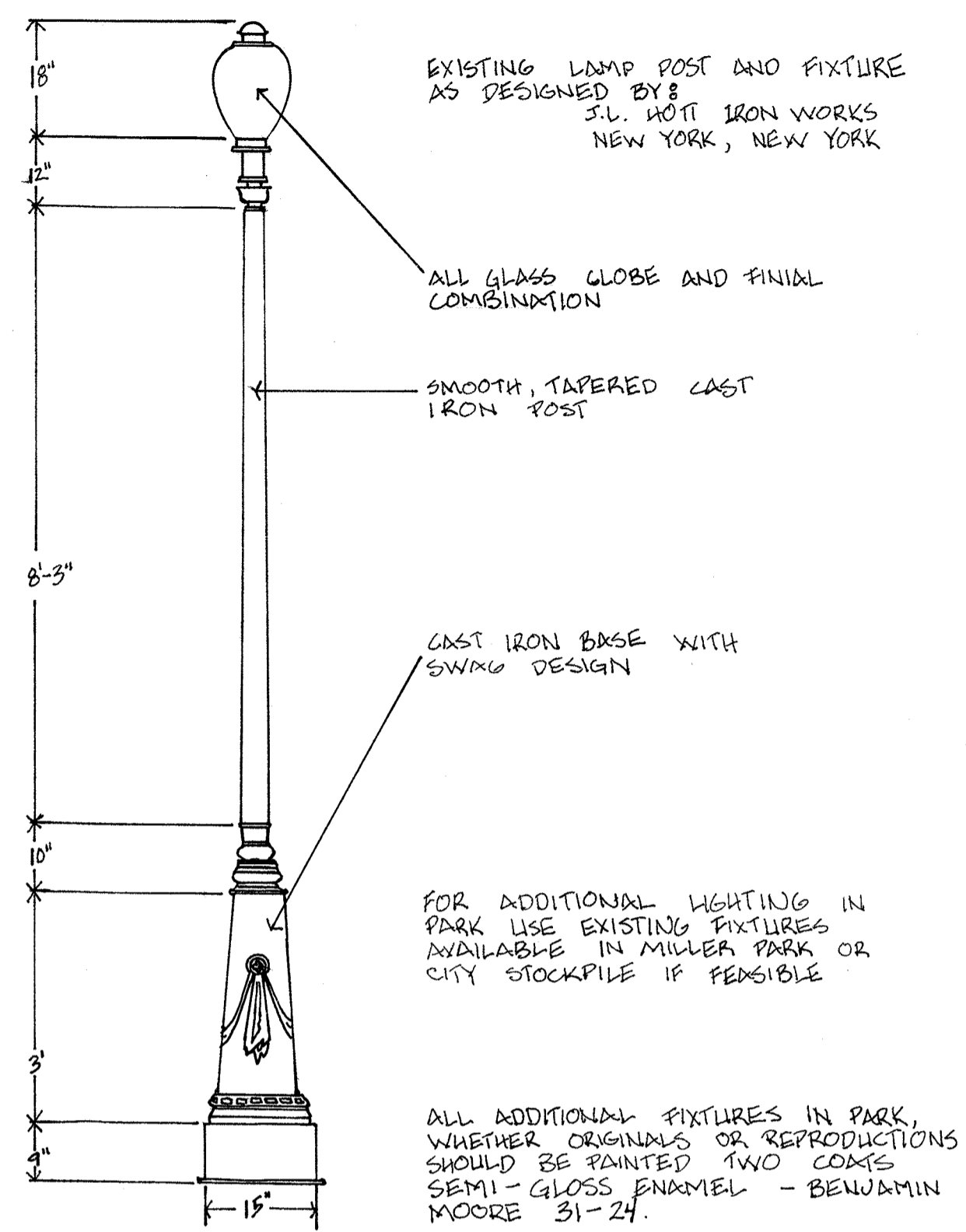

EXISTING FIXT.  
1/2" = 1'-0"

ALTERNATE BENCH DESIGN BY:  
BENCH MANUFACTURING CO.  
5 HOWARD JOHNSON PLAZA  
BOSTON, MASS 02125  
VICTORIAN BENCH MODEL 1876

BENCH FRAME CAST IRON FINISHED  
IN BLACK OR GREEN  
WOODEN SLATS - VARNISHED AND STAIN  
PROVIDE SEATING AREA 4 FEET LONG

IF NOT ENOUGH EXISTING BENCHES CAN  
BE OBTAINED THIS MODEL WILL  
PROVIDE AUTHENTIC ERA REPLACEMENT

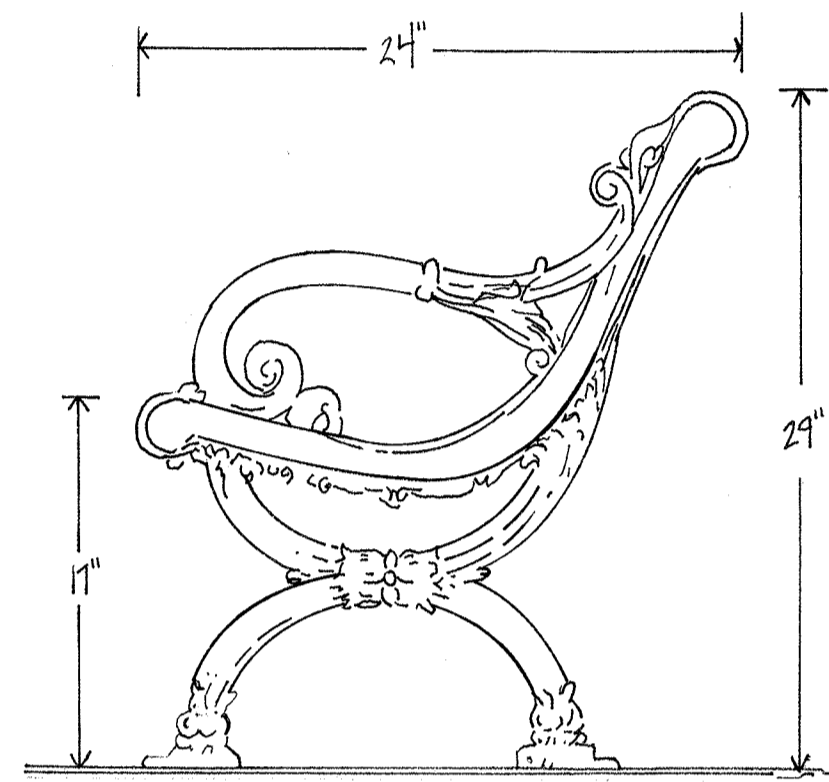

ALTERNATE BENCH  
1/2" = 1'-0"

EXISTING BENCH FROM PARK  
MANUFACTURER UNKNOWN  
CONSTRUCTED ENTIRELY OF BAND IRON  
FRAME, SLATS, BRACING ALL BAND IRON  
ORIGINAL BENCH CAN BE SEEN AT  
CORNER OF TOWANDA AND EMERSON STREETS  
IN BLOOMINGTON, ILL.

ADDITIONAL BENCHES SPECIFIED FOR  
PARK SHOULD BE OF THIS DESIGN EITHER  
ORIGINAL OR REPRODUCED LIKE ORIGINAL  
BAND IRON OR GALVANIZED STEEL REPRODUCTIONS  
CONSTRUCTED BY LOCAL METAL WORKERS POSSIBLE

ALL ADDITIONAL BENCHES IN PARK, ORIGINALS  
OR REPRODUCTIONS SHOULD BE PAINTED TWO  
COATS SEMI-GLOSS ENAMEL - BENJ. MOORE 31-24

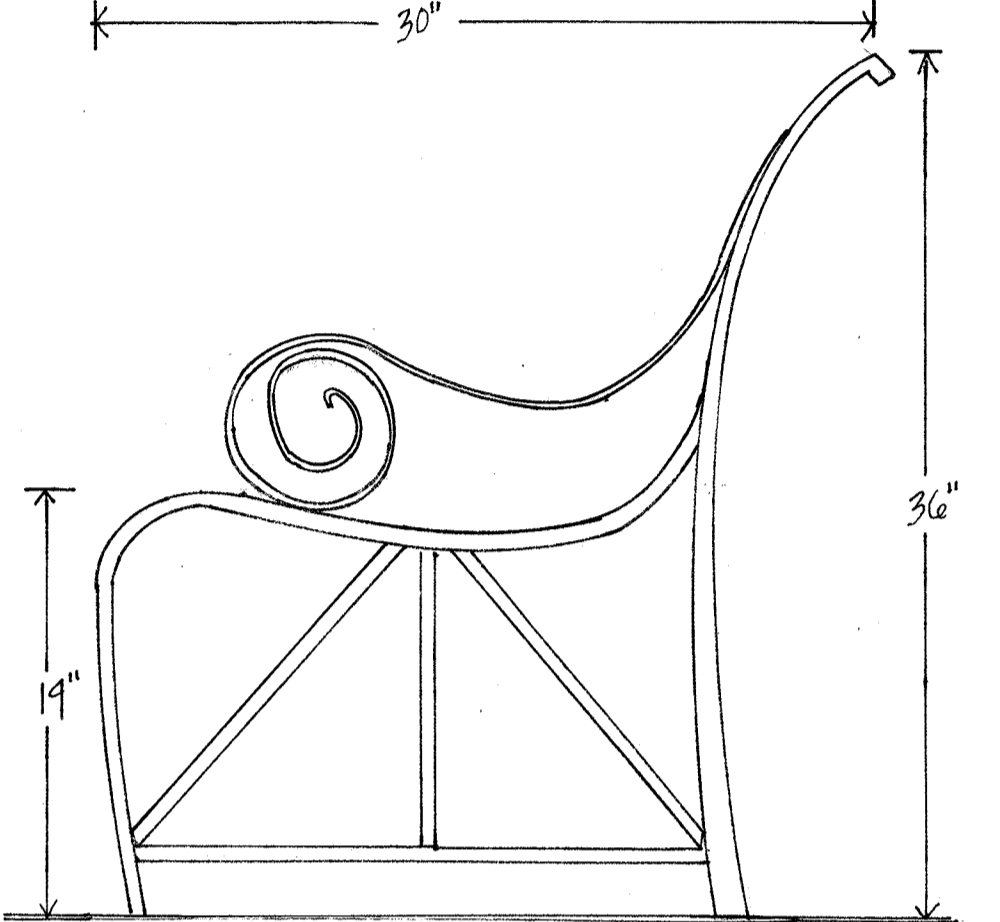

EXISTING BENCH  
1/2" = 1'-0"

REPLACE EXISTING  
FAULTY PLAYGROUND EQUIP.  
WITH NEW SAFE EQUIP.

NEW EQUIPMENT TO BE  
MANUFACTURED BY  
GAME TIME BY TORO  
6874 WASHINGTON AVE. SO.  
EDEN PRARIE, MINN.  
55343

USE STANDARD GALVANIZED  
PIPE RAIL FOR ALL PLAYGROUND  
EQUIP. IF POSSIBLE.

DO NOT USE PLASTIC, "MODERNISTIC"  
DESIGNS, OR HARSH COLORS

ALL NEW PLAYGROUND EQUIP.  
SHOULD BE PAINTED TWO COATS  
SEMI-GLOSS ENAMEL 31-24

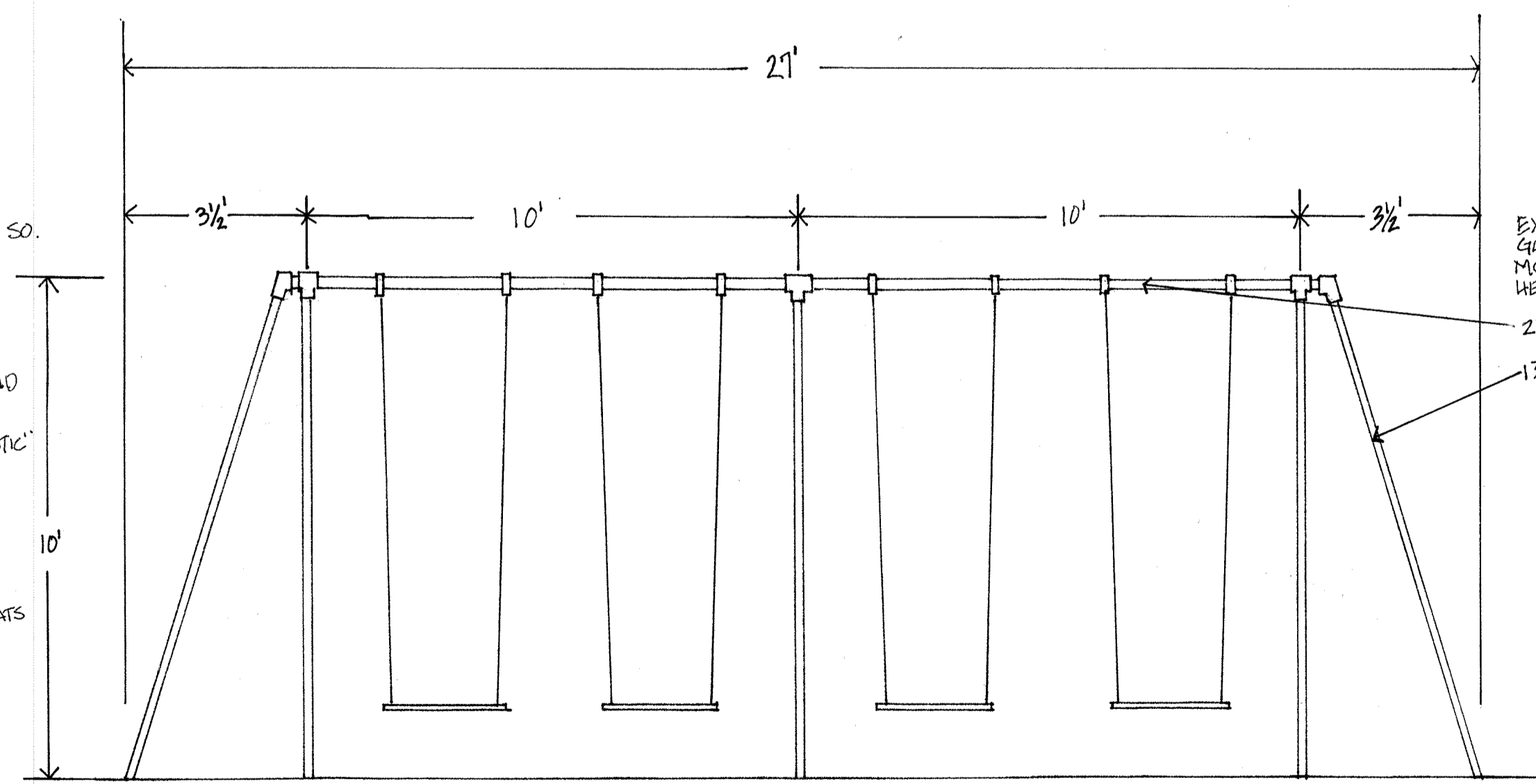

PLAYGROUND EQUIP.  
3/8" = 1'-0"

EXAMPLE SWINGSET BY  
GAME TIME  
MODEL NO. 1004  
HEAVY DUTY TRADITIONAL  
2 3/8" GALVANIZED TOPRAILS  
170" GALVANIZED LEGS

BENJAMIN MOORE  
31-24

NEW TRASH RECEPTACLES  
DESIGNED BY GENERAL DESIGN INC.  
TO BE MANUFACTURED BY  
METAL WORKER OF CITY OF  
BLOOMINGTON'S DESIGNATION

ALL METAL CONSTRUCTION OF  
EITHER BAND IRON OR  
GALVANIZED BAND STEEL

TWO PART CONSTRUCTION  
1. HOLDER TO BE PERMANENTLY  
FIXED TO CONCRETE FOOTING  
2. REMOVABLE INTERIOR BASKET

ALL SURFACES TO BE PAINTED  
TWO COATS  
SEMI-GLOSS  
ENAMEL - BENJAMIN MOORE  
31-24

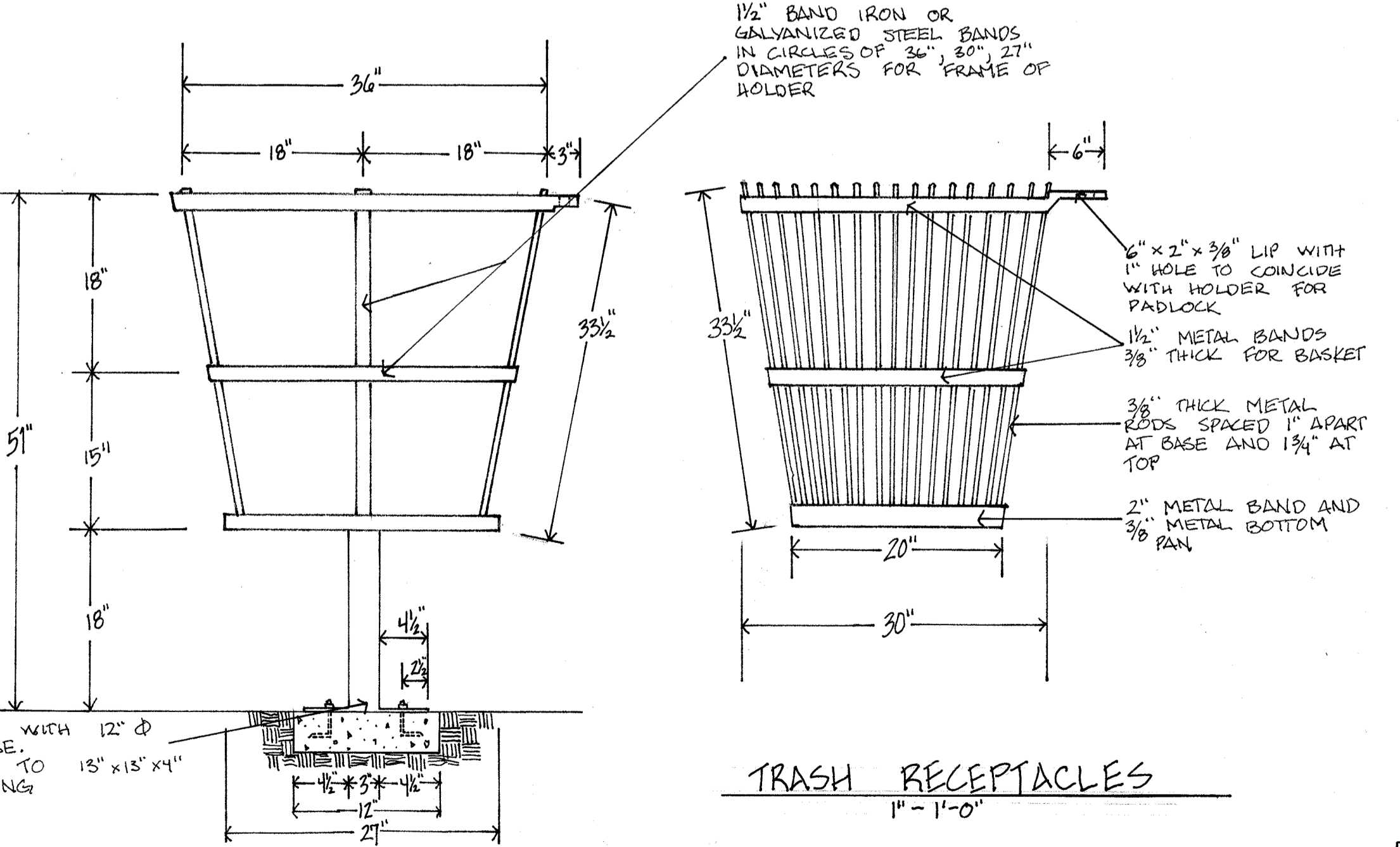

TRASH RECEPTACLES  
1" = 1'-0"

